

# CTR Series

## Turbine Flow Meters with Conditioned Output and Built-in Loading Valve

The CTR series of turbine flow meters with built-in loading valve, provide a complete solution to the flow measurement of hydraulic systems on test stands, machine tools and other fixed or mobile applications. The flow meter can be installed anywhere in the hydraulic circuit for production testing, commissioning, development testing and control systems. The compact design allows the CTR series flow meters to be installed where space is limited.

The integral loading valve provides smooth progressive pressure control in both flow directions allowing components such as cylinders or motors to be tested without re-plumbing the test connections.

The CTR turbine flowmeter has a built-in micro-processor that conditions the signal from the flowmeter to provide an accurate analogue output. This enables you to connect the flowmeter directly into your digital display, PLC or custom DAQ system.

### Specifications

|                                   |   |
|-----------------------------------|---|
| <b>Maximum Rated Pressure:</b>    | 480 bar, 7,000 psi  |
| <b>Maximum Rated Flow:</b>        | 800 L/min, 210 US gpm   |
| <b>Ambient Temperature Range:</b> | 5 to 40 °C, 41 to 104 °F                                      |
| <b>Fluid Temperature Range:</b>   | 5 to 90 °C, 41 to 194 °F                                      |
| <b>Compatible Fluids:</b>         | Mineral oils to ISO 11158. Other fluids consult sales office. |
| <b>Porting:</b>                   | BSPP, SAE   |
| <b>Material:</b>                  | Aluminium   |
| <b>BodyMaterials:</b>             | Aluminium, Steel, Stainless Steel                             |
| <b>Internal Materials:</b>        | FKM   |
| <b>Seals:</b>                     | IP66  |
| <b>IP Rating:</b>                 | 12-32 V d.c   |
| <b>Power Supply:</b>              |   |

### ISO Symbol:

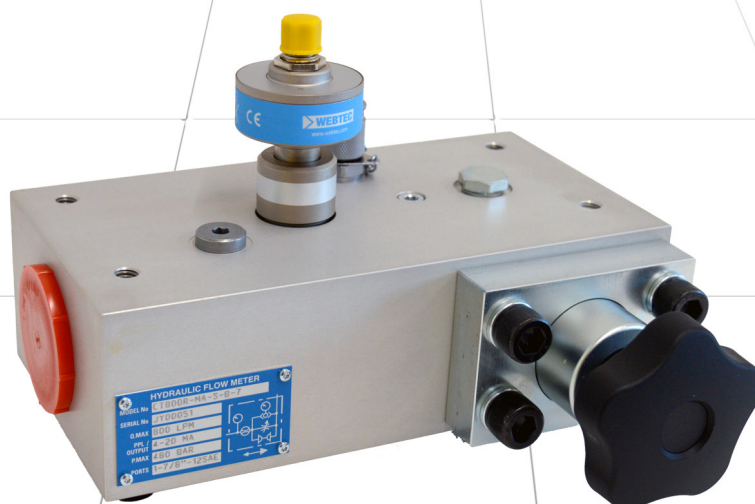
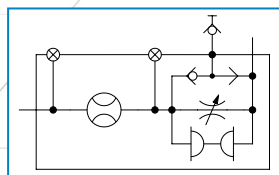

Make it **BLUE**

### Features

- Loading valve with bi-directional flow and pressure loading capability.
- Comprehensive range of accessories available including pressure and temperature transducers, panel meters and cables. For details consult our sales office.
- Output options 4-20 mA or 0-5 V.
- Interpass® safety protection system, bypasses oil internally in the event of the valve being over pressurised in either flow direction.

## Sales Order Code

Please contact our technical sales team to discuss any special order requirements.

| MODEL NUMBER    | OUTPUTS AVAILABLE | MAIN PORTS                           | TOP PORTS              | CALIBRATED FLOW RANGE | MAX RATED PRESSURE |
|-----------------|-------------------|--------------------------------------|------------------------|-----------------------|--------------------|
| CT300R-**-B-B-6 | 5V, mA            | 1" BSPP                              | 1/4" BSPP              | 8 - 300 L/min         | 420 bar            |
| CT300R-**-S-S-6 | 5V, mA            | 1-5/16" -12UN #16 SAE ORB            | 7/16" -20UN #4 SAE ORB | 2 - 80 US gpm         | 6000 psi           |
| CT400R-**-B-B-6 | 5V, mA            | 1" BSPP                              | 1/4" BSPP              | 10 - 400 L/min        | 420 bar            |
| CT400R-**-S-S-6 | 5V, mA            | 1-5/16" -12UN #16 SAE ORB            | 7/16" -20UN #4 SAE ORB | 2.5 - 100 US gpm      | 6000 psi           |
| CT600R-**-F-B-3 | 5V, mA            | 1-1/2" #24 SAE Code 61 4-bolt flange | 1/4" BSPP              | 20 - 600 L/min        | 210 bar            |
| CT600R-**-F-S-3 | 5V, mA            | 1-1/2" #24 SAE Code 61 4-bolt flange | 7/16" -20UN #4 SAE ORB | 5 - 160 US gpm        | 3000 psi           |
| CT600R-**-S-B-7 | 5V, mA            | 1-7/8" -12UN #24 SAE ORB             | 1/4" BSPP              | 20 - 600 L/min        | 480 bar            |
| CT600R-**-S-S-7 | 5V, mA            | 1-7/8" -12UN #24 SAE ORB             | 7/16" -20UN #4 SAE ORB | 5 - 160 US gpm        | 7000 psi           |
| CT800R-**-F-B-3 | 5V, mA            | 1-1/2" #24 SAE Code 61 4-bolt flange | 1/4" BSPP              | 20 - 800 L/min        | 210 bar            |
| CT800R-**-S-B-7 | 5V, mA            | 1-7/8" -12UN #24 SAE ORB             | 1/4" BSPP              | 20 - 800 L/min        | 480 bar            |
| CT800R-**-F-S-3 | 5V, mA            | 1-1/2" #24 SAE Code 61 4-bolt flange | 7/16" -20UN #4 SAE ORB | 5 - 210 US gpm        | 3000 psi           |
| CT800R-**-S-S-7 | 5V, mA            | 1-7/8" -12UN #24 SAE ORB             | 7/16" -20UN #4 SAE ORB | 5 - 210 US gpm        | 7000 psi           |

Note: Replace \*\* with the outputs available code to give complete model number.

CT600R and CT800R has limited pressure control below 86 L/min (23 US gpm).

The maximum controllable pressure in this region is calculated by: max pressure (in bar) = 5 x flow (L/min) + 30

## Flowmeter with Loading Valve Pressure Drop Chart

Hydraulic Oil Viscosity 21 Centistokes

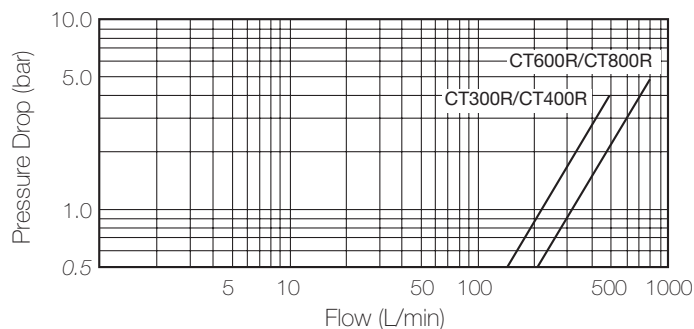

Note

1 UK gallon = 4.546 litres

1 US gallon = 3.785 litres

## Installation Details

| MODEL NUMBER | A  |    | B   |    | C   |       | D   |       | E     |       | F    |       | G   |       | WEIGHT |      |
|--------------|----|----|-----|----|-----|-------|-----|-------|-------|-------|------|-------|-----|-------|--------|------|
| UNITS        | mm | in | mm  | in | mm  | in    | mm  | in    | mm    | in    | mm   | in    | mm  | in    | kg     | lb   |
| CT300        | 49 | 2  | 100 | 4  | 182 | 7-1/8 | 222 | 8-3/4 | 102.5 | 4     | 47.6 | 1-7/8 | 138 | 5-1/2 | 3.7    | 8.1  |
| CT400        | 49 | 2  | 100 | 4  | 182 | 7-1/8 | 222 | 8-3/4 | 102.5 | 4     | 47.6 | 1-7/8 | 138 | 5-1/2 | 3.7    | 8.1  |
| CT600        | 75 | 3  | 125 | 5  | 211 | 8-3/8 | 235 | 9-3/4 | 99    | 3-7/8 | 63   | 2-1/2 | 157 | 6-1/8 | 7.5    | 16.5 |
| CT800        | 75 | 3  | 125 | 5  | 211 | 8-3/8 | 235 | 9-3/4 | 99    | 3-7/8 | 63   | 2-1/2 | 157 | 6-1/8 | 7.5    | 16.5 |

Add 20mm, 3/4" to G for full height including feet.

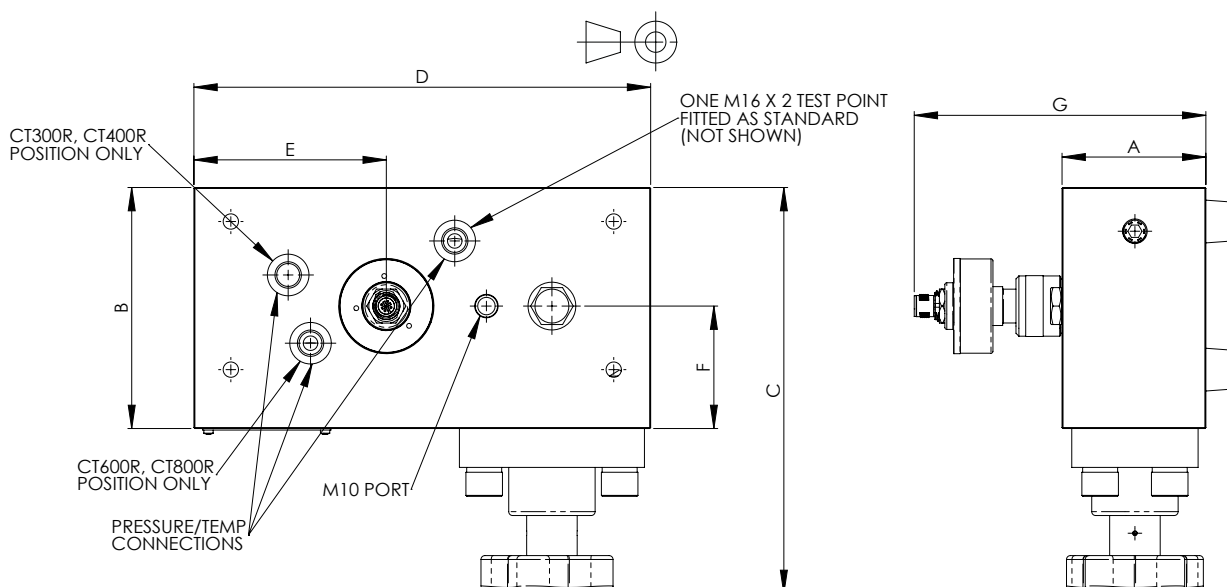

## Connecting Details

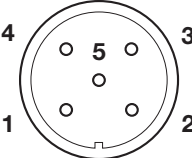
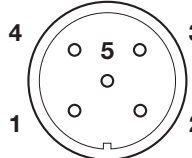
| 5 V  | 4 - 20 mA   |
|--|---|
|  <p><b>Pins</b></p> <p>1 = +In<br/>2 = N/C<br/>3 = 0 - 5 V out<br/>4 = N/C<br/>5 = GND</p> |  <p><b>Pins</b></p> <p>1 = +In<br/>2 = N/C<br/>3 = 4 - 20 mA out<br/>4 = N/C<br/>5 = GND</p> |
| NB. N/C - Do not connect   |   |
| <b>Connecting cable (5 m)</b>  | FT10228-05  |
| <b>Extension cable (5 m)</b>   | FT10229-05  |
| <b>Connector (M12x1 5 pin)</b>   | FT9880  |

## Functional Specification

|                       |  |
|-----------------------|--|
| Accuracy:             | Reading 15% to 100% of flow range - 1% of indicated reading.<br>Readings below 15% of full scale flow - fixed accuracy of 0.15% of full scale. |
| Repeatability:        | Better than $\pm 0.2\%$  |
| Response Time:        | 50 m/s + 1 period (of turbine frequency)   |
| Degree of protection: | CTR-mA, CTR-5V- IP66 (EN60529) With cable connected.   |

## Electrical Specification

|                      |  |
|----------------------|--|
| Supply voltage (VS): | mA & 5 V = 12 - 32 V d.c   |
| Current output:      | 4 - 20 mA, 3 wire loop, max loop resistance = (VS x 50) - 200 ohms |
| Voltage output:      | 0 - 5 V d.c, current consumption = 10 mA, minimum load 20 k ohms   |
| Zero & FSD:          | 4 mA and 0 V = zero flow<br>20 mA, 5 V = FSD                       |
| Over-range:          | +5% FSD (20.8 mA, 5.25 V)  |

## Construction Materials

|             |  |
|-------------|--|
| Flow body:  | 600/800 High tensile Aluminium 2014A T6<br>300/400 High tensile Aluminium 2011 T6                                      |
| Transducer: | Body and nut - Steel 212A42 electroless nickel plated<br>Housing and Lid - Aluminium 2011 T3 electroless nickel plated |

## Operation

There are two key elements - the turbine and the loading valve. As fluid is passed through the flow block it rotates a precision turbine. The flow straighteners and turbine design minimise the effects of turbulence and swirl. The turbine blades are detected by the magnetic reluctance transducer which produces a pulse output. The flow meter block has ports for pressure or temperature sensors which can be supplied as an option.

The integrated loading valve gives progressive pressure loading in either direction. Replaceable safety burst discs are part of Interpass® safety protection system and operate if maximum pressure is exceeded, relieving flow to the return line. Replacement safety discs are stored in an internal holder machined in the rear of the flowblock.

## Reverse Flow

The flow block is capable of controlling and measuring flow in either direction. There is a shuttle valve which ensures the pressure port measure the high pressure side of the loading valve. In order to achieve the quoted accuracy figures flow must be in the preferred direction - turbine first then loading valve.

## Calibration

All CTR turbine flow meter are calibrated at a mean viscosity of 21 cSt using ISO32 hydraulic mineral oil to ISO11158 category HM. Calibration certificates are available on request - this is a chargeable option. Other calibration on request - please consult the sales office.

## Installation

The flow block has built-in flow straighteners so the normal recommended length of 10 Ø of straight tube can be reduced to 8Ø where space is limited. Inlet and outlet connections should always be of a similar bore size to that of the flow block to prevent venturi or constriction effects.

The range of flow meters can be used for intermittent or continuous testing of flow in either direction. The flow block can be mounted in any orientation. For heavy duty applications where the flow block will be used constantly with continuous pressure spikes please contact sales to discuss your application.

## Filtration

Must be better than DIN ISO4406: 21/19/16 or NAS 10 (typically achieved with 20-20u filters).

## Top ports

Most flow meters have two additional ports (see table for configuration) in the top face to enable the user to connect both a temperature and pressure sensor. All flow meters come with one M16 x 2 test point fitted as standard.

## Turbine Flow Meters

### Accuracy

The accuracy is better described as the uncertainty of the flow reading compared to a known reference. Every flow measurement has an error associated with it, caused by the combination of a large number of factors that affect the operation of the flow meter, these include bearing friction, temperature, viscosity, magnetic drag and the signal strength to name but a few.

All our flow meters are calibrated at 10 points over the flow range and its performance measured against a flow reference that is traceable to International standards. Accuracy is typically quoted in one of two ways: as a percentage of full scale (the maximum calibrated flow) or as a percentage of the indicated reading (the actual flow).

### Full scale (FS) or full scale deflection (FSD)

A term that was originally used for analogue displays where a needle pointed to a number on a scale, hence FSD. The flow accuracy is a fixed amount regardless of the actual flow you are measuring. For example 1% FS for a flow meter with a maximum calibrated flow of 400 L/min is  $\pm 4$  L/min whether you are measuring 40 L/min, 200 L/min or 400 L/min (see graph below). If you need to measure flows of 40 and 400 L/min with same flow meter then it is important to check the allowable error at all flows.

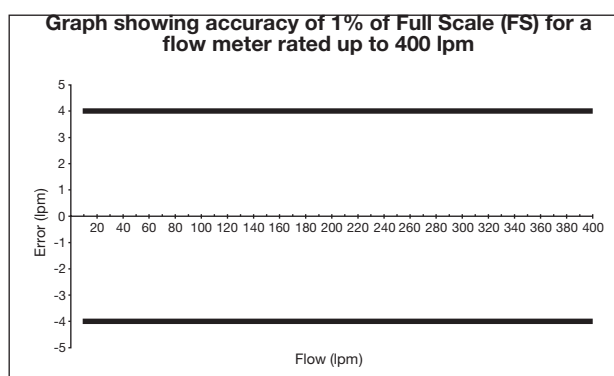

### Indicated reading (IR)

Accuracy is quoted as a percentage of the actual value measured. So if the accuracy of a 400 L/min flow meter is 1% IR then the error at 400 L/min is  $\pm 4$  L/min. As the actual flow measured reduces, so does the error in L/min. When measuring a flow of 60 L/min with an accuracy of 1% IR, the possible error is  $\pm 0.6$  L/min. At very low flows, the possible errors are no longer proportional to the flow rate, but actually a fixed amount in L/min (see graph below). For example if the accuracy is quoted as 1% IR (>60 L/min) for a flow meter with the range 10 - 400 L/min, then the accuracy is 1% of the actual flow in the range 60 to 400 L/min and a fixed flow error in the range 10 to < 60 L/min.

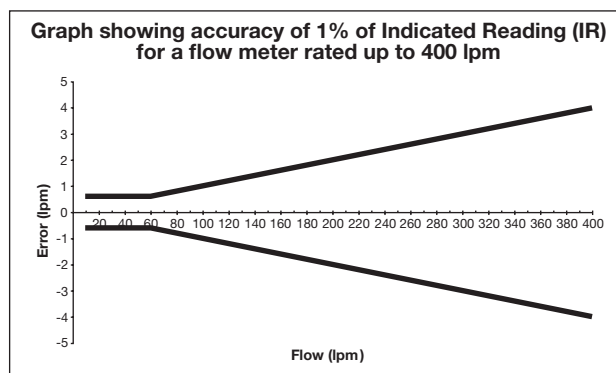

## Repeatability

The repeatability is the variation in the performance of the flow meter when used under the same conditions. Our range of flow meters has excellent repeatability of better than  $\pm 0.2\%$ . This is just as important as the accuracy since in many applications the flow readings from the same flow meter will be compared at regular intervals to look for any change in performance of the system.

## Flow range (Turndown ratio)

A turbine flow meter has a minimum and a maximum calibrated flow which together describe the range of flows that can be accurately measured. Through the addition of signal conditioning either mounted on the flow meter or built into the readout, the flow range of our flow meters has been extended considerably compared to other models on the market; the ratio of the maximum to the minimum calibrated flow (turndown ratio) is between 15 and 40 across all models. Particular effort has been made to extend the flow range by calibrating down to lower flows enabling one flow meter to be used where two may have been required in the past. This makes the flow meter both a more economical and easier to install solution.

## Fluid viscosity

The performance of a turbine flow meter can be affected by the viscosity of the fluid measured. Our turbine flow meters are calibrated at between 18 and 26 cSt as standard (a mean viscosity of 21 cSt), which is the typical kinematic viscosity for a hydraulic fluid operating at 50 °C. The kinematic viscosity of all hydraulic fluids is related to the fluid temperature and the table below shows the affect of temperature on the kinematic viscosity of a range of typical grades of hydraulic oil.

The shaded area of the table shows the range of viscosities that can be measured by a flow meter with standard calibration with minimal effect on the accuracy (less than  $\pm 1\%$  FS).

Flow meters can be specially calibrated at a different viscosity to the standard or we can advise on the expected error when the flow meter is used at other viscosities, please contact sales for further information.

**Table showing kinematic viscosity (cSt) of different mineral oils at specific temperatures**

| TEMP °C | FLUID TYPE |       |       |       |       |       |
|---------|------------|-------|-------|-------|-------|-------|
|         | ISO15      | ISO22 | ISO32 | ISO37 | ISO46 | ISO68 |
| 0       | 85.9       | 165.6 | 309.3 | 449.6 | 527.6 | 894.3 |
| 10      | 49.0       | 87.0  | 150.8 | 204.7 | 244.9 | 393.3 |
| 20      | 30.4       | 50.5  | 82.2  | 105.5 | 127.9 | 196.1 |
| 30      | 20.1       | 31.6  | 48.8  | 59.8  | 73.1  | 107.7 |
| 40      | 14.0       | 21.0  | 31.0  | 36.6  | 44.9  | 63.9  |
| 50      | 10.2       | 14.7  | 20.8  | 23.9  | 29.4  | 40.5  |
| 60      | 7.7        | 10.7  | 14.7  | 16.5  | 20.2  | 27.2  |
| 70      | 6.0        | 8.1   | 10.9  | 12.0  | 14.6  | 19.2  |
| 80      | 4.8        | 6.4   | 8.4   | 9.1   | 11.1  | 14.3  |
| 90      | 4.0        | 5.2   | 6.6   | 7.2   | 8.7   | 11.1  |
| 100     | 3.3        | 4.3   | 5.5   | 6.0   | 7.1   | 8.9   |