

580

Sonde di temperatura con cablaggio
Temperature probes with cable

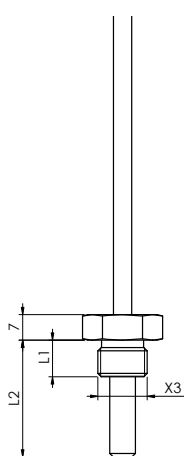
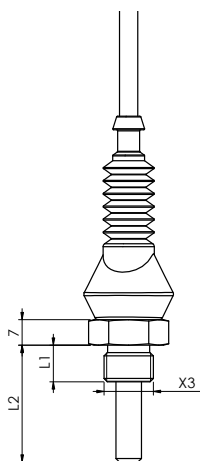
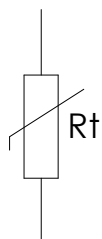
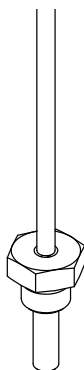
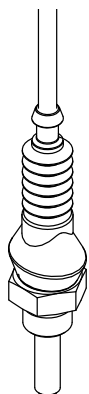

18

hidra[matic]

Downloaded from: www.hidramatic.com



A richiesta disponibile la versione per alta temperatura
Version Higt Temperature available on request



Le sonde sono personalizzabili in base alle esigenze del cliente per quanto riguarda:

- il cablaggio, il connettore
- la timbratura, utile all'identificazione della sonda stessa (nome azienda, codice della sonda, data di produzione ecc.)
- temperatura Max/Min di lavoro

Our probes can be customized according to customer's requirements regarding:

- wiring, connector
- marking for probe's identification (e.g. Company name, part number, date of production)
- Max/Min temperature working

Termistore	NTC - PTC - PT 100 - PT 1000
Copertura termistore	resina
Corpo	ottone (a richiesta INOX)
Filettature (X3) e quote L1 - L2	(a richiesta)
Temperatura di lavoro	-20 / +120°C (altri a richiesta)
Grado di protezione	IP67

Thermistor	NTC - PTC - PT 100 - PT 1000
Thermistor Coat	resin
Case	brass (on request stainless steel)
Threads (X3) and L1 - L2	(on request)
Working temperature	-20 / +120°C (others on request)
Protection degree	IP67

Per un corretto impiego vedere le note generali del catalogo "Sensori di Temperatura" Euroswitch edizione 2013.
For a correct use please refer to "General Notes" in the "Temperature sensors" Euroswitch catalogue, edition 2013.

Modello 580 - Connettori integrati

Model 580 - Integrated connectors

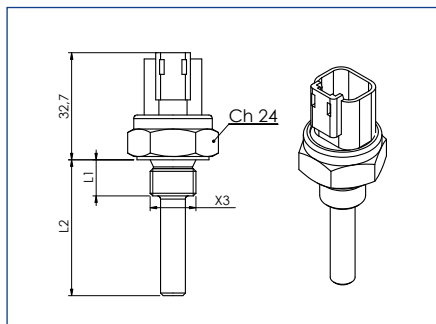

Connettore Deutsch DT 04-2P
Connector Deutsch DT 04-2P

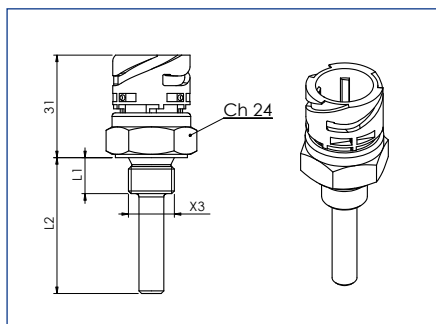

Connettore a baionetta DIN72585
Bajonet connector DIN72585

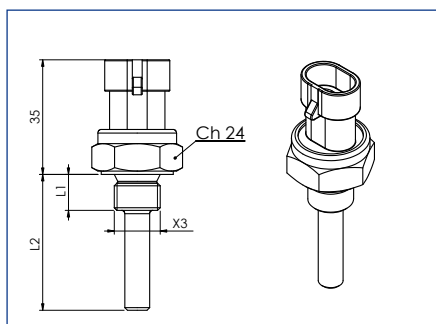

Connettore tipo AMP
Superseal 1.5 2 vie
Connector type AMP
Superseal 1.5 2 way

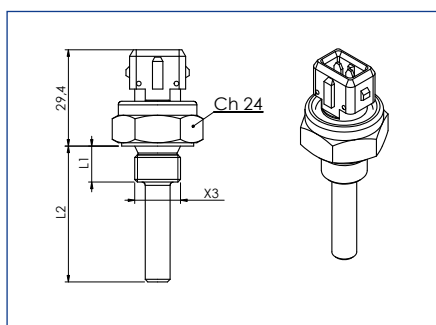

Connettore Tipo AMP Junior
Power Timer
Connector Type AMP Junior
Power Timer

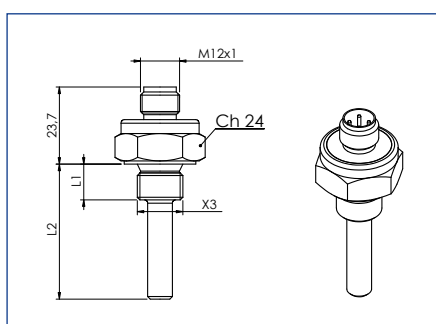

Connettore tipo M12x1
Connector type M12x1